

Ski Tuning Workbench Supports

Here is a simple design for an inexpensive ski tuning vise. Materials are 24" of 2x6 lumber, carpenter's glue, six 2" finish nails, one foot of foam rubber weatherstripping, and two 7" C-clamps.

1) Cut two pieces of 2x6 each 9" long and two pieces 2.5" long. In each of the two longer pieces cut a notch 1/2" wide and 1.5" long as shown in the diagram below:

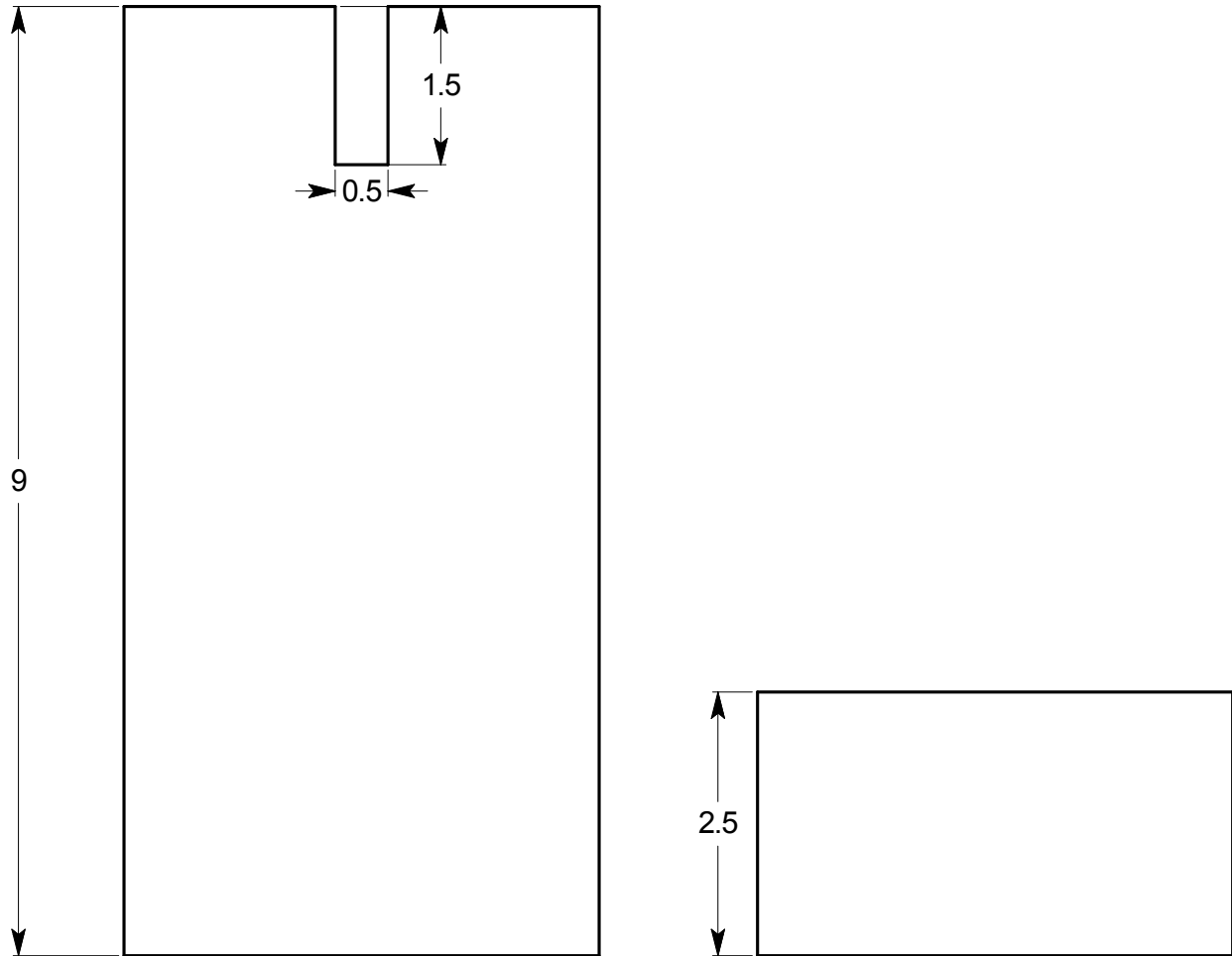

To cut the notch you can make several parallel saw cuts and chisel or drill out the bottom of the notch.

2) Glue and nail the short block onto the bottom of the long block as shown in the next photo. Repeat with the other two blocks to make a second support. Sand and finish (if desired). Attach some rubber foam weather stripping at the top (white material) for padding. In the photo below I wrapped the top with black duct tape to protect skis from scratches, but this is not really necessary.



3) To use - clamp the smaller block to a bench or table using 7" C-clamps. In the photo below the vise supports are clamped to a 4ft long piece of scrap plywood laid across two saw horses. The notches hold skis vertically (as shown) so that you can work on the edges. To work on the bottoms, just lay the ski upside down across the padded tops of the supports. This is enough support as is, but you can also lasso the binding with a heavy bungee cord and attach each end of the cord to the workbench, to really hold the ski down.



4) Go ski.